



Circular connectors





- ✓ Standard DIN EN 61076-2-105
- ✓ Degree of protection IP67
- ✓ Material of contacts: Brass, gold plated
- ✓ Solder/Dip solder/Crimping/Litz wires for panel mount connector
- ✓ Customized cable length, PVC/PUR cable are optional

M5 threaded connector is one of the smallest connectors in industrial automation. It is mainly developed and designed for sensors with 5mm connection diameter, which is also widely used in the application field of small size and delicate parts such as industrial measurement camera, electric bicycle signal transmission in recent years. M5 connector is very compact and suitable for installation applications in devices with tight or limited space.

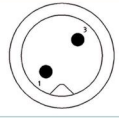
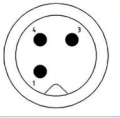
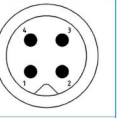
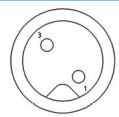

Circular Connector

M5 Contact arrangement

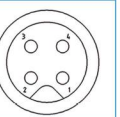
M5 Contact arrangement			
Male			
	2pins	3pins	4pins
			
	2pins	3pins	4pins

M5 Core colors			
	Core color	Core color	Core color
	2pins	3pins	4pins
1	棕色/brown	棕色/brown	棕色/brown
2	—	—	白色/white
3	蓝色/blue	蓝色/blue	蓝色/blue
4	—	黑色/black	黑色/black

Male Nuts



Hexagonal nut



Female Nuts



Hexagonal nut



Drawing

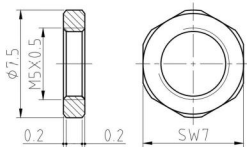

Drawing

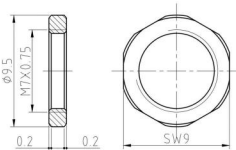

Male Contacts

焊接款 Solder Type	PCB款 PCB/Dip Solder Type	压接款 Crimping Type
-----------------	--------------------------	-------------------



Female Contacts

焊接款 Solder Type	PCB款 PCB/Dip Solder Type	压接款 Crimping Type
-----------------	--------------------------	-------------------



M5 技术参数 Technical Parameters

设计标准Design Standard		DIN EN 61076-2-105
芯数Contacts:	2, 3, 4	
电流Current:	1A	
电压Voltage:	60V	
耐压Withstanding Voltage:	800V	
线规Wire Gauge:	26AWG-30AWG	
材质Material:	PA66, 铜镀金/PA66, Brass Gold Plated	
机械寿命Mechanical Operation:	≧ 100 插拔周期/Mating Cycles	
接触电阻Contact Resistance:	3mΩ	
工作温度Operation Temperature:	-25℃ ~ +85℃	
防护等级Protection Rate:	IP67	
盐雾Salt Mist:	48h	
所有材料符合ROHS要求 All materials meet ROHS requirements		

Moldable Connector

M5 moldable male plug, knurling



Drawing

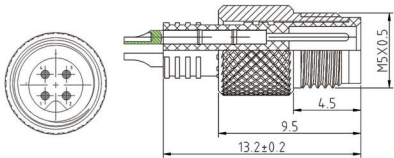

编码 Doding	A
芯数 Contacts	2, 3, 4

M5 moldable male plug, knurling, shielded



Drawing

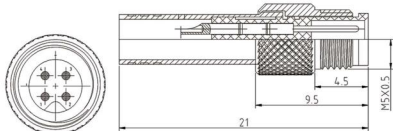

编码 Doding	A
芯数 Contacts	2, 3, 4

M5 moldable female plug, knurling



Drawing

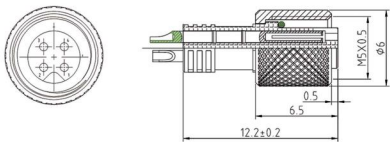

编码 Doding	A
芯数 Contacts	2, 3, 4

M5 moldable female plug, knurling, shielded



Drawing

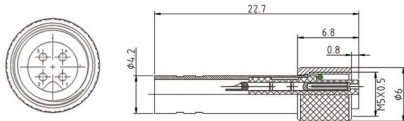

编码 Doding	A
芯数 Contacts	2, 3, 4

Molded Cable

M5 molded male cable, knurling



Drawing

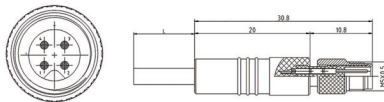

编码 Doding	A
芯数 Contacts	2, 3, 4

M5 molded male cable, knurling shielded



Drawing

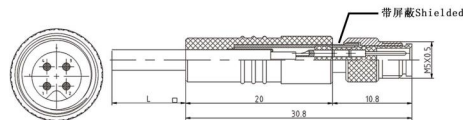

编码 Doding	A
芯数 Contacts	2, 3, 4

M5 molded angled male cable, knurling



Drawing

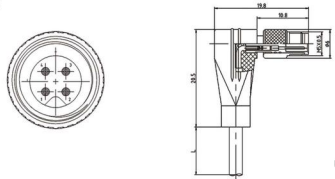

编码 Doding	A
芯数 Contacts	2, 3, 4

M5 molded angled male cable, knurling, shielded



Drawing

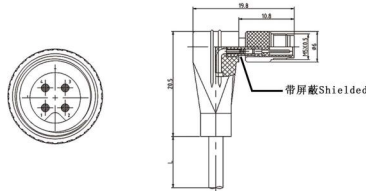

编码 Doding	A
芯数 Contacts	2, 3, 4

Molded Cable

M5 molded female cable, knurling



Drawing

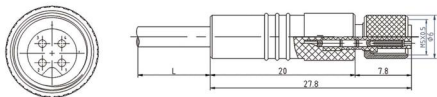

编码 Doding	A
芯数 Contacts	2, 3, 4

M5 molded female cable, knurling, shielded



Drawing

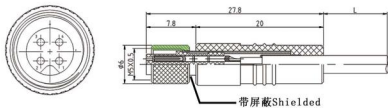

编码 Doding	A
芯数 Contacts	2, 3, 4

M5 molded angled female cable, knurling



Drawing

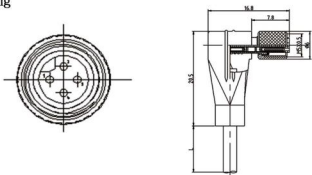

编码 Doding	A
芯数 Contacts	2, 3, 4

M5 molded angled female cable, knurling, shielded



Drawing

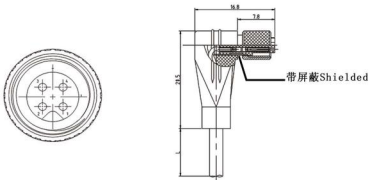

编码 Doding	A
芯数 Contacts	2, 3, 4

Panel Mount Connector

M5 front fastened male socket, M5*0.5



Drawing

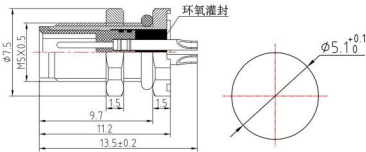

编码 Doding	A
芯数 Contacts	2, 3, 4

M5 front fastened male socket dip solder, M5*0.5



Drawing

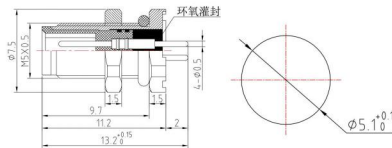

编码 Doding	A
芯数 Contacts	2, 3, 4

M5 rear fastened male socket, M5*0.5



Drawing

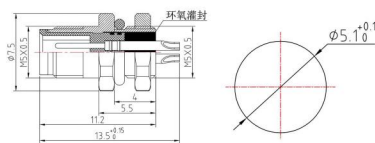

编码 Doding	A
芯数 Contacts	2, 3, 4

M5 front fastened female socket, M7*0.75



Drawing

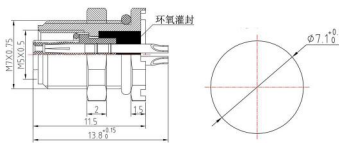

编码 Doding	A
芯数 Contacts	2, 3, 4

Panel Mount Connector/with Wires

M5 front fastened female socket dip solder M7*0.75



Drawing

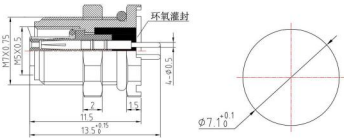

编码 Doding	A
芯数 Contacts	2, 3, 4

M5 front fastened male socket, M5*0.5



Drawing

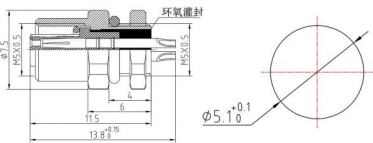

编码 Doding	A
芯数 Contacts	2, 3, 4

M5 front fastensd male socket with wire, M5*0.5



Drawing

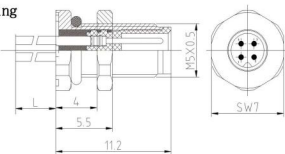

编码 Doding	A
芯数 Contacts	2, 3, 4

M5 rear fastened male socket with wire,M5*0.5



Drawing

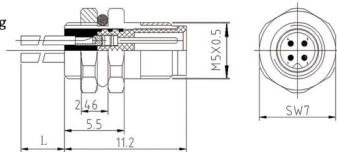

编码 Doding	A
芯数 Contacts	2, 3, 4

Panel Mount Connector with Wires/Accessories

M5 front fastened female socket with wire M7*0.75



Drawing

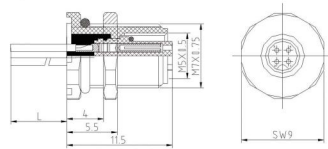

编码 Doding	A
芯数 Contacts	2, 3, 4

M5 rear fastened female socket with wire M5*0.5



Drawing

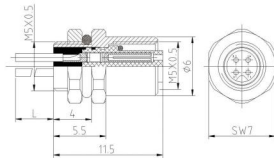

编码 Doding	A
芯数 Contacts	2, 3, 4

M5 Plastic Receptacle



Drawing

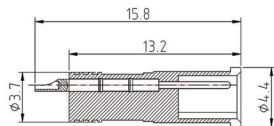

编码 Doding	A
芯数 Contacts	2, 3, 4

M5 plastic male dust cover



Drawing

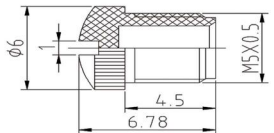

编码 Doding	A
芯数 Contacts	2, 3, 4